

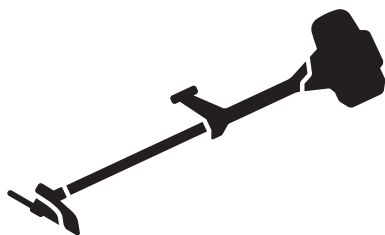

Husqvarna®



535iFR, 535iRXT, 535iRX

Contents

Introduction.....	2	Troubleshooting.....	26
Safety.....	4	Transportation, storage and disposal.....	26
Assembly.....	11	Technical data.....	27
Operation.....	17	Accessories.....	28
Maintenance.....	24	EC Declaration of Conformity.....	30

Introduction

Product description

This product is a battery operated grass trimmer/brushcutter with an electrical motor.

Work is constantly in progress to increase your safety and efficiency during operation. Speak to your servicing dealer for more information.

Intended use

Use the product with a saw blade, a grass blade or a trimmer head to cut different types of vegetation. Do not

use the product for other tasks than grass trimming, grass clearing and forestry clearing. Use a saw blade to cut fibrous types of wood. Use a grass blade or trimmer head to cut grass.

Note: National or local regulations can regulate the use. Comply to given regulations.

Only use the product with accessories that are approved by the manufacturer. Refer to *Accessories on page 28*.

Product overview

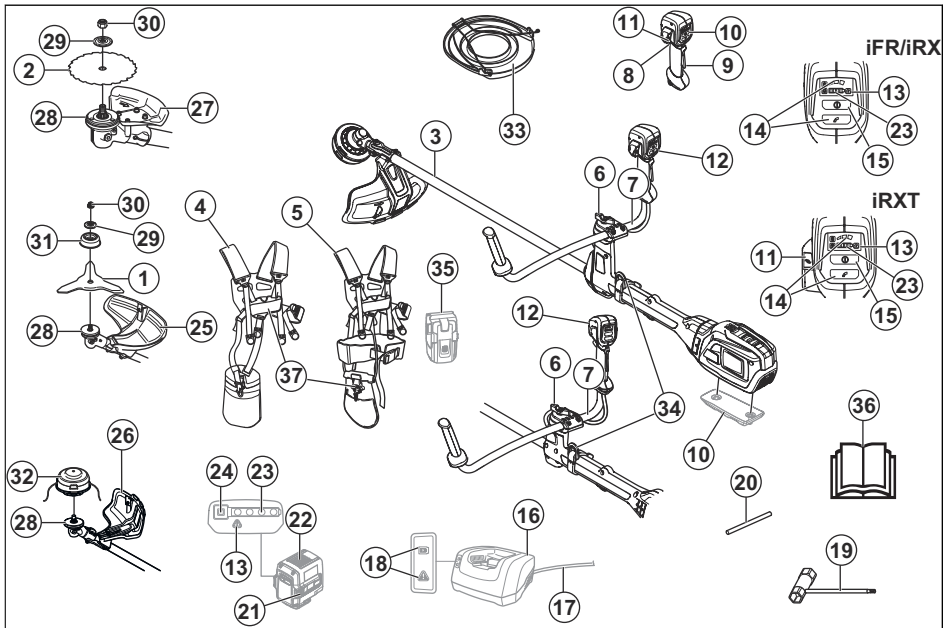

- | | |
|-----------------------|--|
| 1. Grass blade | 4. Balance 55 Harness (535iFR, 535iRX) |
| 2. Saw blade (535iFR) | 5. Balance XB Harness (535iRXT) |
| 3. Shaft | 6. Knob |

7. Handlebar
8. Power trigger
9. Power trigger lockout
10. Add-on weight (accessory)
11. ErgoFeed button (535iRXT)
12. Handle
13. Warning indicator (LED)
14. Speed mode button
15. Start/Stop button
16. Charger
17. Charger cable
18. Power on and Warning indicator (LED)
19. Combination wrench
20. Locking pin
21. Battery release buttons
22. Battery
23. State of charge
24. Battery indicator button
25. Grass blade guard
26. Trimmer guard
27. Saw blade guard (535iFR)
28. Drive disc
29. Washer
30. Locknut
31. Support cup
32. Trimmer head
33. Transport guard
34. Harness support hook
35. Battery carrier (accessory)
36. Operator's manual
37. Quick-release mechanism

Symbols on the product



WARNING! This product can be dangerous! Careless or incorrect use can result in serious or fatal injury to the operator or others. It is extremely important that you read and understand the contents of the operator's manual. Please read the operator's manual carefully and make sure you understand the instructions before the product is used.



Use a protective helmet in locations where objects can fall on you. Use approved hearing protection. Use approved eye protection.



Maximum speed of the output shaft.



The product can cause objects to eject, which can cause injury.



The product complies with the applicable EU directives.



Keep a minimum distance of 15 m to persons and animals during operation of the product.



Risk of blade thrust if the cutting equipment touches an object that it does not immediately cut. The product can cut off body parts. Keep a minimum of 15 m distance to persons and animals during operation of the product.



Use approved protective gloves.



Use heavy-duty slip-resistant boots.



Only use a flexible cutting wire. Do not use metal cutting elements.



Protected against splashing water.



Noise emissions to the environment according to European Directive 2000/14/EC and New South Wales legislation "Protection of the Environment Operations (Noise Control) Regulation 2017". Noise emission data can be found on the machine label and in the Technical data chapter.



Symbols on the product or its packaging indicate that this product cannot be handled as domestic waste. This product must be deposited at an appropriate recycling facility.



Direct current.



Keep all parts of your body away from the hot surfaces.



If the product features *Bluetooth*® wireless technology. The *Bluetooth*® symbol will be marked on the product name label. Refer to *Husqvarna Connect* on page 17.

yyyywwxxxx

The rating plate shows the serial number. **yyyy** is the production year, **ww** is the production week and **xxxx** is the sequential number.

Note: Other symbols/decals on the product refer to certification requirements for other commercial areas.

Manufacturer

Husqvarna AB

Drottninggatan 2, SE-561 82 Huskvarna, Sweden, tel:
+46-36-146500

Product liability

As referred to in the product liability laws, we are not liable for damages that our product causes if:

- the product is incorrectly repaired.
- the product is repaired with parts that are not from the manufacturer or not approved by the manufacturer.
- the product has an accessory that is not from the manufacturer or not approved by the manufacturer.
- the product is not repaired at an approved service center or by an approved authority.

Safety

Safety definitions

Warnings, cautions and notes are used to point out specially important parts of the manual.



WARNING: Used if there is a risk of injury or death for the operator or bystanders if the instructions in the manual are not obeyed.



CAUTION: Used if there is a risk of damage to the product, other materials or the adjacent area if the instructions in the manual are not obeyed.

Note: Used to give more information that is necessary in a given situation.

General power tool safety warnings



WARNING: Read all safety warnings, instructions, illustrations and specifications provided with this power tool. Failure to follow all instructions listed below may result in electric shock, fire and/or serious injury.

- **Save all warnings and instructions for future reference.** The term "power tool" in the warnings refers to your mains-operated (corded) power tool or battery-operated (cordless) power tool.

Work area safety

- **Keep work area clean and well lit.** Cluttered or dark areas invite accidents.
- **Do not operate power tools in explosive atmospheres, such as in the presence of flammable liquids, gases or dust.** Power tools create sparks which may ignite the dust or fumes.
- **Keep children and bystanders away while operating a power tool.** Distractions can cause you to lose control.

Electrical safety

- **Power tool plugs must match the outlet. Never modify the plug in any way. Do not use any adapter plugs with earthed (grounded) power tools.** Unmodified plugs and matching outlets will reduce risk of electric shock.
- **Avoid body contact with earthed or grounded surfaces, such as pipes, radiators, ranges and refrigerators.** There is an increased risk of electric shock if your body is earthed or grounded.
- **Do not expose power tools to rain or wet conditions.** Water entering a power tool will increase the risk of electric shock.
- **Do not abuse the cord. Never use the cord for carrying, pulling or unplugging the power tool. Keep cord away from heat, oil, sharp edges or moving parts.** Damaged or entangled cords increase the risk of electric shock.
- **When operating a power tool outdoors, use an extension cord suitable for outdoor use.** Use of a cord suitable for outdoor use reduces the risk of electric shock.
- **If operating a power tool in a damp location is unavoidable, use a residual current device (RCD) protected supply.** Use of a RCD reduces the risk of electric shock.

Personal safety

- **Stay alert, watch what you are doing and use common sense when operating a power tool. Do not use a power tool while you are tired or under the influence of drugs, alcohol or medication.** A moment of inattention while operating power tools may result in serious personal injury.
- **Use personal protective equipment. Always wear eye protection.** Protective equipment such as dust mask, non-skid safety shoes, hard hat or hearing protection used for appropriate conditions will reduce personal injuries.
- **Prevent unintentional starting. Ensure the switch is in the off-position before connecting to power source**

and/or battery pack, picking up or carrying the tool.

Carrying power tools with your finger on the switch or energising power tools that have the switch on invites accidents.

- **Remove any adjusting key or wrench before turning the power tool on.** A wrench or a key left attached to a rotating part of the power tool may result in personal injury.
- **Do not overreach. Keep proper footing and balance at all times.** This enables better control of the power tool in unexpected situations.
- **Dress properly. Do not wear loose clothing or jewellery. Keep your hair and clothing away from moving parts.** Loose clothes, jewellery or long hair can be caught in moving parts.
- **If devices are provided for the connection of dust extraction and collection facilities, ensure these are connected and properly used.** Use of dust collection can reduce dust-related hazards.
- **Do not let familiarity gained from frequent use of tools allow you to become complacent and ignore tool safety principles.** A careless action can cause severe injury within a fraction of a second.

Power tool use and care

- **Do not force the power tool. Use the correct power tool for your application.** The correct power tool will do the job better and safer at the rate for which it was designed.
- **Do not use the power tool if the switch does not turn it on and off.** Any power tool that cannot be controlled with the switch is dangerous and must be repaired.
- **Disconnect the plug from the power source and/or remove the battery pack, if detachable, from the power tool before making any adjustments, changing accessories, or storing power tools.** Such preventive safety measures reduce the risk of starting the power tool accidentally.
- **Store idle power tools out of the reach of children and do not allow persons unfamiliar with the power tool or these instructions to operate the power tool.** Power tools are dangerous in the hands of untrained users.
- **Maintain power tools and accessories. Check for misalignment or binding of moving parts, breakage of parts and any other condition that may affect the power tool's operation. If damaged, have the power tool repaired before use.** Many accidents are caused by poorly maintained power tools.
- **Keep cutting tools sharp and clean.** Properly maintained cutting tools with sharp cutting edges are less likely to bind and are easier to control.
- **Use the power tool, accessories and tool bits etc. in accordance with these instructions, taking into account the working conditions and the work to be performed.** Use of the power tool for operations different from those intended could result in a hazardous situation.

- **Keep handles and grasping surfaces dry, clean and free from oil and grease.** Slippery handles and grasping surfaces do not allow for safe handling and control of the tool in unexpected situations.

Battery tool use and care

- **Recharge only with the charger specified by the manufacturer.** A charger that is suitable for one type of battery pack may create a risk of fire when used with another battery pack.
- **Use power tools only with specifically designated battery packs.** Use of any other battery packs may create a risk of injury and fire.
- **When battery pack is not in use, keep it away from other metal objects, like paper clips, coins, keys, nails, screws or other small metal objects, that can make a connection from one terminal to another.** Shorting the battery terminals together may cause burns or a fire.
- **Under abusive conditions, liquid may be ejected from the battery; avoid contact. If contact accidentally occurs, flush with water. If liquid contacts eyes, additionally seek medical help.** Liquid ejected from the battery may cause irritations or burns.
- **Do not use a battery pack or tool that is damaged or modified.** Damaged or modified batteries may exhibit unpredictable behaviour resulting in fire, explosion or risk of injury.
- **Do not expose a battery pack or tool to fire or excessive temperature.** Exposure to fire or temperature above 130 °C may cause explosion.
- **Follow all charging instructions and do not charge the battery pack or tool outside the temperature range specified in the instructions.** Charging improperly or at temperatures outside the specified range may damage the battery and increase the risk of fire.
- **Remove the battery pack from the tool before making adjustments, changing accessories, or storing the tool.** Such preventive safety measures reduce the risk of starting the battery tools accidentally.

Service

- **Have your power tool serviced by a qualified repair person using only identical replacement parts.** This will ensure that the safety of the power tool is maintained.
- **Never service damaged battery packs.** Service of battery packs should only be performed by the manufacturer or authorized service providers.

Other general safety information

- Deactivate the product before you move to another area. Always remove the battery when passing the product to another person.
- Never put the product down unless you have deactivated it and removed the battery. Do not leave the product unsupervised when it is switched on.

- The cutting tool does not stop immediately after the product is turned off.
- The blade should be completely stopped once the trigger switch has returned to the initial position.
- Before using the product and after any impact, check for signs of wear or damage and repair as necessary.
- If anything jams in the cutting attachment while you operate the product, stop and deactivate the product. Make sure that the cutting attachment stops completely. Remove the battery before you clean, inspect or repair the product and/or the cutting equipment.
- Do a check of the product before use. Refer to, *Safety on page 4* and *Maintenance on page 24*. Do not use a defective product. Do the safety checks, maintenance and service instructions described in this manual.
- Faulty cutting attachment can increase the risk of accidents.
- Check the gear for dirt and cracks. Clean off grass and leaves from the gear using a brush. Gloves should be worn when necessary.
- Always ensure that ventilation openings are kept clear of debris.
- Check that the trimmer head is completely attached to the trimmer.
- All covers, guards and handles must be fitted before starting.
- Check that the product is in perfect working order. Check that all nuts and screws are tight.
- Check that the trimmer head and trimmer guard are not damaged or cracked. Replace the trimmer head or trimmer guard if it has been exposed to impact or are cracked. Always use the recommended guard for the cutting attachment you are using. See chapter on Technical data.
- This product is a dangerous tool if you are not careful or if you use the product incorrectly. This product can cause serious injury or death to the operator or others.
- This appliance is not intended for use by persons (including children) with reduced physical, sensory or mental capabilities, or lack of experience and knowledge, unless they have been given supervision or instruction concerning use of the appliance by a person responsible for their safety. Children should be supervised to ensure that they do not play with the appliance.
- Never allow children to use or be in the vicinity of the machine. Since the machine is easy to start, children may be able to start it if they are not kept under full surveillance. This can mean a risk of serious personal injury. Therefore disconnect the battery when the machine is not under close supervision.
- Never allow children or other persons not trained in the use of the product and/or the battery to use or service it.
- National or local regulations may regulate the use. Comply to given regulations.
- Store the equipment in a lockable area so that it is out of reach of children and unauthorized persons.
- The transport guard must always be used for storage and transport.
- Keep hands and feet away from the cutting area at all times and especially when switching on the motor.
- Keep your hands and feet away from the cutting attachment until it has stopped completely when the product is deactivated.
- Do not remove the cut material, or let other persons remove cut material, while the product is activated or the cutting equipment rotates, as this can result in serious injury.
- Keep in mind that it is you, the operator that is responsible for not exposing people or their property to accidents or hazards.
- Under no circumstances may the design of the product be modified without the permission of the manufacturer. Always use original accessories. Non-authorized modifications and/or accessories can result in serious personal injury or the death of the operator or others. Your warranty may not cover damage or liability caused by the use of non-authorized accessories or replacement parts.
- The only accessories you can operate with this product are the cutting attachments recommended in the technical data chapter.
- Never use a product that has been modified in any way from its original specification
- Never use a product that is faulty. Carry out the safety checks, maintenance and service instructions described in this manual. Some maintenance and service measures must be carried out by trained and qualified specialists. See instructions under the Maintenance heading.
- Working in bad weather is tiring and often brings added risk. Due to the added risk, it is not recommended to use the machine in very bad weather, for instance in dense fog, heavy rain, strong winds, intense cold, risk of lightning, etc
- Never work from a ladder, stool or any other raised position that is not fully secured.
- Store Idle Appliances Indoors – When not in use, appliances should be stored indoors
- It is not possible to cover every conceivable situation you can face. Always exercise care and use your common sense. Avoid all situations which you consider to be beyond your capability. If you still feel uncertain about operating procedures after reading these instructions, you should consult an expert before continuing.
- Ensure that no people or animals come closer than 15 meters while you work. When several operators are working in the same area the safety distance should be at least 15 metres. Otherwise there is a risk of serious personal injury. Stop the product

immediately if anyone approaches. Never swing the product around without first checking behind you to make sure that no one is within the safety zone.

- If anything jams in the cutting attachment while you operate the product, stop and deactivate the product. Make sure that the cutting attachment stops completely. Remove the battery before you clean, inspect or repair the product and/or the cutting equipment.
- Ensure that people, animals or other things can not affect your control of the product or that they do not come in contact with the cutting attachment or loose objects that are thrown out by the cutting attachment. However, do not use the product unless you are able to call for help in the event of an accident.
- Make sure that you can move and stand safely. Check the area around you for possible obstacles (roots, rocks, branches, ditches, etcetera) in case you have to move suddenly. Take great care when you work on sloping ground.
- Walk, never run.
- Inspect the working area. Remove all loose objects, such as stones, broken glass, nails, steel wire, string etc. that could be thrown out or become wrapped around the cutter or cutter guard.
- Watch out for stumps of branches that can be thrown out when you cut. Do not cut too close to the ground where stones and other objects can be thrown out.
- Make sure that no clothes or parts of the body come in contact with the cutting attachment when the product is activated. Keep the product below waist level.
- Watch out for thrown objects. Always wear approved eye protection. Never lean over the cut-ting attachment guard. Stones, rubbish, etc., can be thrown up into the eyes which can cause blindness or serious injury.
- Listen out for warning signals or shouts when you wear hearing protection. Always remove your hearing protection as soon as the product stops.
- If any unwanted vibrations occur, tap out new line to give the line the correct length to stop the vibrations.
- If the product starts vibrating abnormally, stop the product and remove the battery.
- Overexposure to vibration can lead to circulatory damage or nerve damage in persons who have poor circulation. Speak to your physician if you experience symptoms of overexposure to vibration. Such symptoms include numbness, loss of feeling, tingling, pricking, pain, loss of strength, changes in skin color or condition. These symptoms usually show in the fingers, hands or wrists.
- Always hold the product with both hands. Hold the product on the right side of your body.

Personal protective equipment



WARNING: Read the warning instructions that follow before you use the product.

- Always use approved personal protective equipment when you use the product. Personal protective equipment cannot fully prevent injury but it decreases the degree of injury if an accident does occur. Let your dealer help you select the right equipment.
- Use a protective helmet where there is a risk of falling objects.

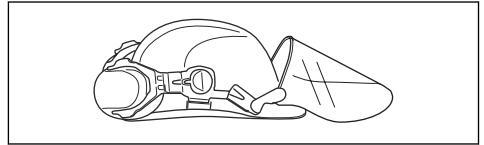

- Use approved hearing protection that provides adequate noise reduction. Long-term exposure to noise can result in permanent hearing impairment.

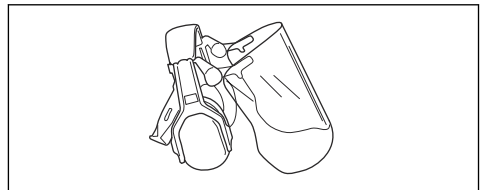

- Use approved eye protection. If you use a visor, you must also use approved protective goggles. Approved protective goggles must comply with the ANSI Z87.1 standard in the USA or EN 166 in EU countries.

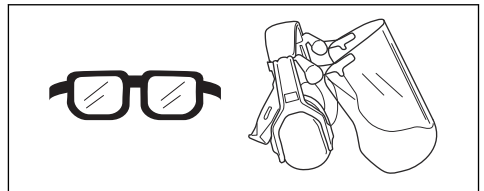

- Use gloves when necessary, for example when you attach, examine or clean the cutting equipment.

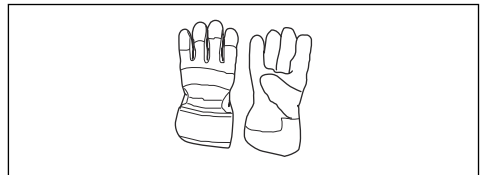

- Use sturdy non-slip boots.

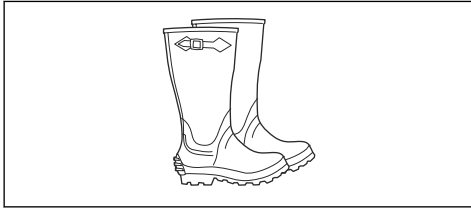

- Use clothing made of a strong fabric. Always use heavy, long pants and long sleeves. Do not use loose clothing that can catch on twigs and branches. Do not wear jewelry, short pants, sandals or go with bare feet. Put your hair up safely above shoulder level.
- Keep first aid equipment close at hand.



Safety devices on the product



WARNING: Read the warning instructions that follow before you use the product.

In this section the product's safety features, its purpose and how checks and maintenance should be carried out to ensure that it operates correctly. See instructions under the heading *Product overview on page 2* to find where these parts are located on your product.

The life span of the product can be reduced and the risk of accidents can increase if product maintenance is not carried out correctly and if service and/or repairs are not carried out professionally. If you need further information please contact your nearest servicing dealer.



WARNING: Never use a product with defective safety components. The product's safety equipment must be inspected and maintained as described in this section. If your product fails any of these checks, contact your service agent to get it repaired.



CAUTION: All servicing and repair work on the machine requires special training. This is especially true of the machine's safety equipment. If your machine fails any of the checks described below you must contact your service agent. When you buy any of our products we guarantee the availability of professional repairs and service. If the retailer who sells your machine is not a

servicing dealer, ask him for the address of your nearest service agent.

To do a check of the power trigger lockout

The power trigger lockout prevents accidental operation. When you push the power trigger lockout forward (A) and then press the power trigger lockout against the handle (B), the power trigger (C) is released. When you release the handle, the power trigger and the power trigger lockout move back to their initial positions. This movement is operated by independent springs.

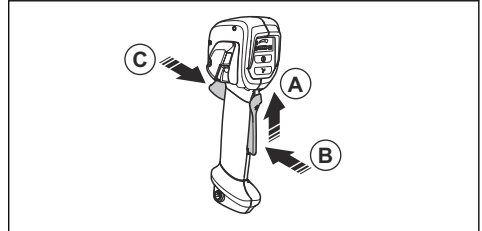

1. Make sure that the power trigger is locked when the lock is in its initial position.

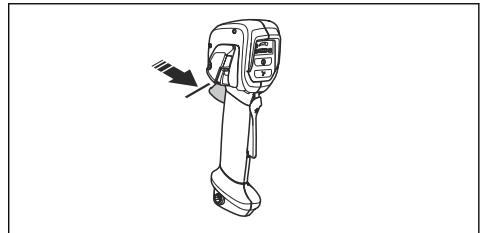

2. Press the power trigger and make sure that it goes back to its initial position when you release it.

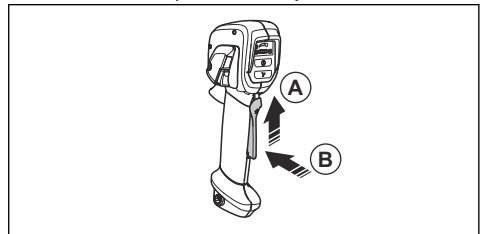

3. Make sure that the power trigger and the lock moves freely and that the return spring operates correctly.

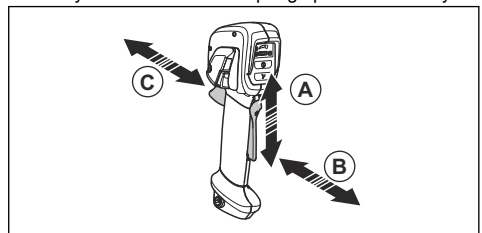

4. Start the product, refer to *To start the product on page 19*.
5. Apply full speed.
6. Release the power trigger and make sure that the cutting attachment stops fully.

To do a check of the user interface

1. Push and hold the start/stop button (A).

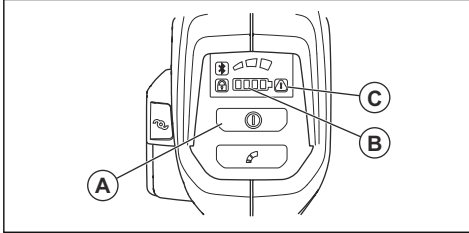

- a) The product is on when the LED (B) is on.
 - b) The product is off when the LED (B) is out.
2. If the warning indicator (C) comes on or flashes, refer to *Troubleshooting on page 26*.

To do a check of the vibration damping system (535iRXT, 535iRX)

The vibration damping system decreases vibration in the handles to a minimum which makes the operation easier. The vibration damping system of the product decreases the vibration from the cutting attachment to the handlebar and handles.

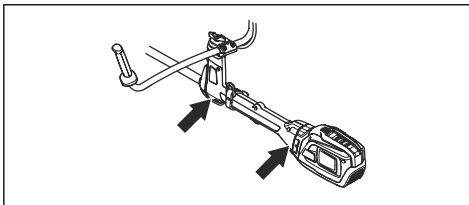

1. Stop the product.
2. Do a visual check for deformation and damage, for example, cracks.
3. Push the anti-vibration suspension lightly and make sure that it can move slightly in all directions.

To do a check of the quick release function



WARNING: Do not use a harness with a defective quick release function.

1. Stop the motor.
2. Do a visual check for damage for example, cracks.

3. Release and attach the quick release mechanism to make sure that it operates correctly.

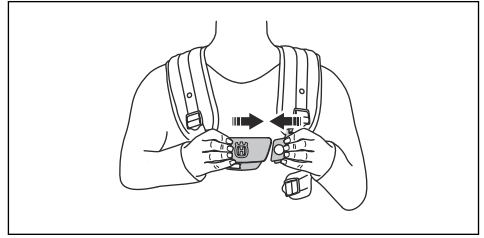

4. If the harness has a hip pad and a hip strap, make sure that the quick release function operates correctly.

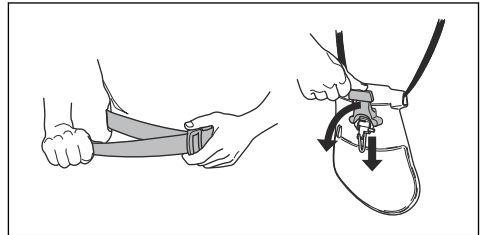

To do a check of the cutting attachment guard



WARNING: Do not use a cutting attachment without an approved and correctly attached cutting attachment guard. Always use the recommended cutting attachment guard for the cutting attachment that you use, see *Accessories on page 28*. If an incorrect or faulty cutting attachment guard is attached this can cause serious personal injury.

The cutting attachment guard stops objects that ejects in the direction of the operator. It also prevents injuries that occur if you touch the cutting attachment.

1. Stop the product and remove the battery.
2. Do a visual check for damages, for example cracks.

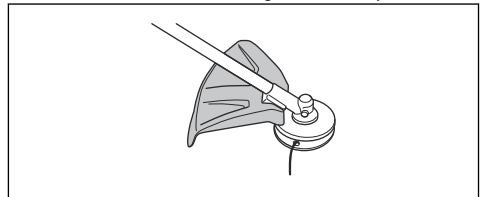

3. Replace the cutting attachment guard if it is damaged.

To attach and remove the locknut



WARNING: Stop the product and remove the battery, use protective gloves and be

careful around the sharp edges of the cutting attachment.

A locknut is used to attach some types of cutting attachments. The locknut has a left thread.

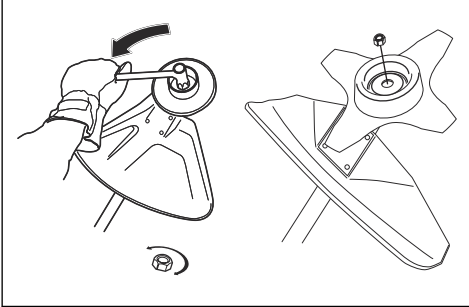

- To attach, tighten the locknut in the opposite direction to the direction of rotation of the cutting attachment.
- To remove the locknut, undo the lock nut in the same direction as the cutting attachment rotates.
- To loose and tighten the locknut, use a socket spanner with a long shaft. The arrow in the picture shows the area where you should operate the socket spanner.



WARNING: When you loose and tighten the locknut there is a risk of injury from the teeth of the saw blade. You should therefore always ensure that your hand is shielded by the blade guard when you do this.

Note: Make sure that you can not turn the locknut by hand. Replace the nut if the nylon lining does not have a resistance of a minimum of 1.5 Nm. The nut should be replaced after it has been put on approximately 10 times.

Cutting attachment



WARNING: Remove the battery and make sure that the cutting attachment stops completely before you work on any part of the cutting attachment.



WARNING: Use correct cutting attachment. Only use the cutting attachment with the guards we recommend, refer to *Accessories on page 28*. Make sure that the cutting attachment is sharpened correctly. A cutting attachment that is not sharpened correctly increases the risk of blade thrust.



WARNING: An incorrectly sharpened or damaged blade increases the risk of accidents. Keep the teeth of the blade correctly sharpened. Follow the instructions and use the recommended file gauge.



WARNING: A coasting blade can cause injury while it continues to spin after the switch has been released. Need to maintain proper control until the blade has completely stopped rotating.



CAUTION: An incorrectly set saw blade increases the risk of jamming and blade thrust. This can damage the saw blade. Keep the correct setting on the saw blade. Follow the instructions and use the recommended setting tool.

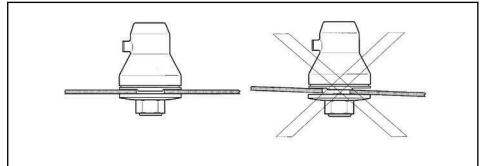

Wear protective gloves when the cutting attachment is handled.

- Use the saw blade to cut fibrous types of wood.
- Use the blades and grass knives to cut coarse grass.
- Use the trimmer head to trim grass.
- Check the cutting attachment for damage or cracks. Replace a damaged cutting attachment.

Trimmer head

- Always use the correct trimmer head, cutting attachments and always use the recommended trimmer line. Refer to *Accessories on page 28* and the assembly in the end of the Manual.
- Make sure that the cutter on the trimmer guard is not damaged.
- Make sure that the trimmer line is wound tightly and equally around the drum to prevent unusual vibrations from the product. Different cord lengths can result in vibrations that are not necessary. Tap the trimmer head to get correct length on the cord.

To increase the life of the cord it can be soaked in water for 2 days or more before assembly. This will make the cord more resistant.

Saw blade and grass blade

- Use correctly sharpened blades. An incorrectly sharpened or damaged blade increases the risk of injury.

- Use correctly set blades. Correct blade set is 1 mm. An incorrectly set blade increases the risk of injury and damage.
- To sharpen and set the blade correctly, refer to the instructions that come with the blade.
- Remove the battery before you do maintenance, other checks or assemble the product.
- The operator must only do the maintenance and servicing shown in this operator's manual. Turn to your servicing dealer for maintenance and servicing of a larger extension.
- Do not clean the battery or the battery charger with water. Strong detergent can cause damage to the plastic.
- If you do not do maintenance, it decreases the life cycle of the product and increases the risk of accidents.
- Special training is necessary for all servicing and repair work, especially for the safety devices on the product. If not all checks in this operator's manual are approved after you have done maintenance, turn to your servicing dealer. We guarantee that there are professional repairs and servicing available for your product.
- Keep the teeth of the blade correctly sharpened. Obey our recommendations. Also refer to the instructions on the blade package.
- Only use original spare parts.
- Always use heavy duty gloves when you repair the cutting attachment. The blades are very sharp and can easily cause injuries.

Safety instructions for assembly



WARNING: Read, understand and obey these instructions carefully before you use the product.

- Remove the battery from the product before you assemble the product.
- Use approved protective gloves.
- When you use a saw blade or a grass blade, make sure that the correct handlebar, the blade guard and the harness are attached to the product.
- A defective or incorrect guard can cause injury. Do not use a cutting attachment that does not have an approved guard attached.
- Make sure that you assemble the cover and shaft correct before you start the product.
- The drive disc and support flange must engage correctly in the centre hole of the cutting attachment. A cutting attachment that is attached incorrectly can cause injury or death.
- To operate the product safely and prevent injury to the operator or other persons, the product must always be attached correctly to the harness.

Safety instructions for maintenance



WARNING: Read the warning instructions that follow before you do maintenance on the product.

Assembly

To attach the handle

1. Remove the nut and screw from the bottom of the handle.
2. Attach the handle onto the handlebar.

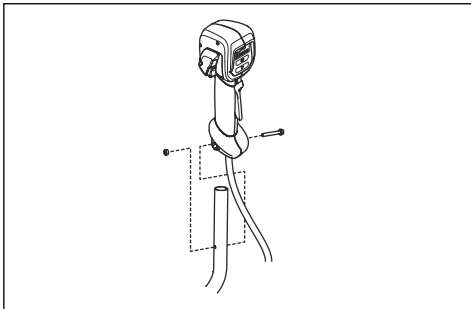

3. Align the screw hole in the handle with the screw hole in the handlebar.
4. Put the screw into the screw hole at the bottom of the handle and through the handlebar.
5. Attach the nut on the screw and tighten the nut.

To assemble the handlebar

1. Put the handlebar into the bracket.

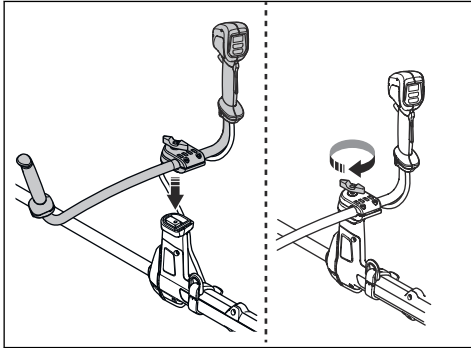

2. Attach the knob but do not tighten fully.
3. Adjust the handlebar to put the product in a good operation position.

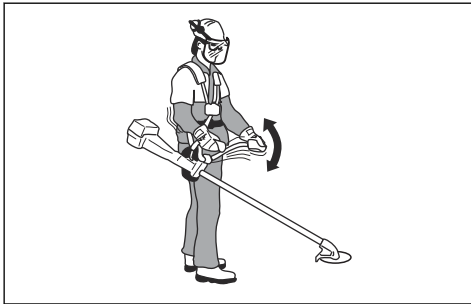

4. Tighten the knob fully.

To put the handlebar in transport position

1. Loosen the knob.
2. Turn the handlebar until it is parallel to the shaft.
3. Turn the handlebar around the shaft.

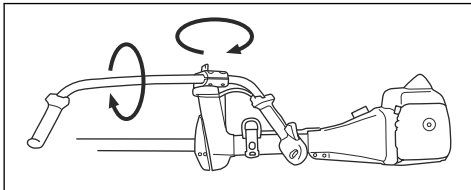

4. Tighten the knob.

To assemble the cutting equipment

The cutting equipment includes a cutting attachment and a cutting attachment guard.



WARNING: Stop the product and remove the battery. Use protective gloves.



WARNING: Always use the cutting attachment guard that is recommended for the cutting attachment. See *Accessories on page 28*.



WARNING: An incorrectly attached cutting attachment can result in injury or death.

Cutting equipment and guards



WARNING: Stop the product and remove the battery. Use protective gloves.

The product have different cutting attachment guards for the cutting equipment that can be used. Make sure that you use the correct cutting attachment guard for the cutting equipment. Refer to *Accessories on page 28*.

- Grass blade guard and grass blade.

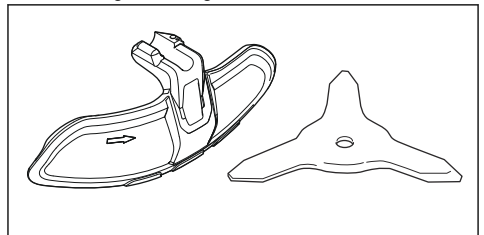

- Trimmer guard and trimmer head.

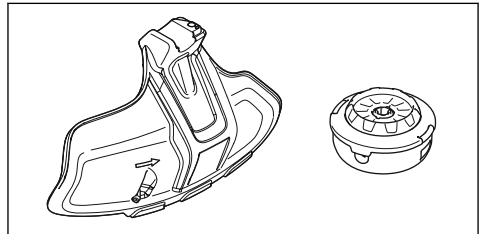

- Saw blade guard and saw blade.

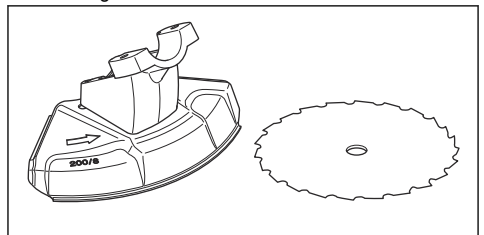

Assembly of the grass blade guard and the grass blade

To attach the grass blade guard

- Put the grass blade guard (A) onto the shaft and tighten the bolt.

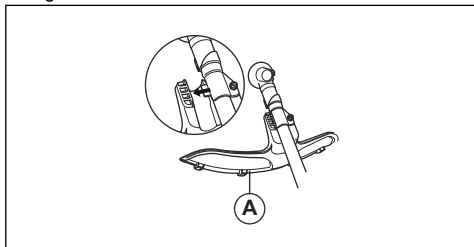

To remove the grass blade guard

- Remove the bolt and remove the grass blade guard (A) from the shaft.

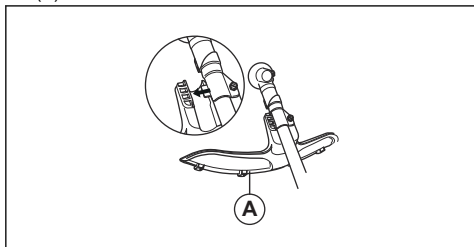

To attach the grass blade

- Put the gear of the product on a flat surface to make sure that the blade is assembled correctly.
- Turn the output shaft to align one of the holes in the drive disc (B) with the related hole in the gear housing.
- Put the locking pin (C) in the hole to lock the shaft.
- Put the grass blade (D), the support cup (E) and the support flange (F) on the output shaft.

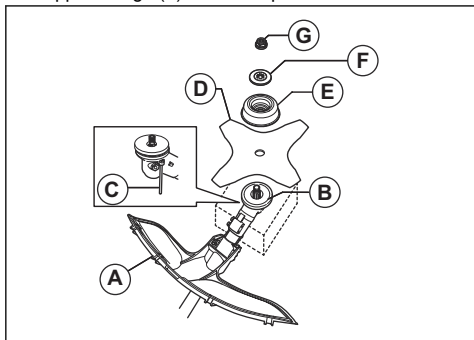

- Make sure that the drive disc and support flange engages correctly in the center hole of the grass blade.

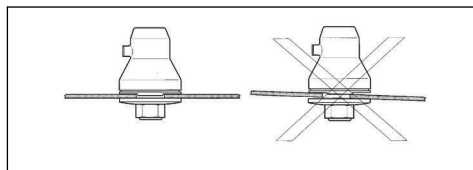

- Attach the nut (G).
- Tighten the nut with the socket wrench. Hold the shaft of the socket wrench near the blade guard. Tighten in the opposite direction to how the cutting attachment rotates. Tighten it to a torque of 35-50 Nm.

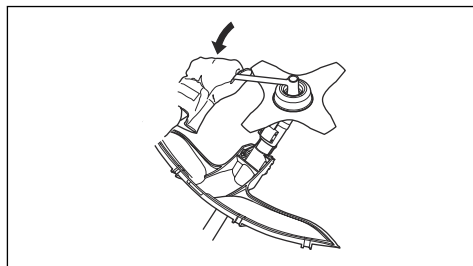

To remove the grass blade

- Put the gear of the product on a flat surface to make sure that the blade is removed correctly.
- Put the locking pin (C) into the hole on the shaft to lock the shaft.
- Remove the nut (G).
- Remove the support flange (F), the support cup (E) and the grass blade (D) from the output shaft.

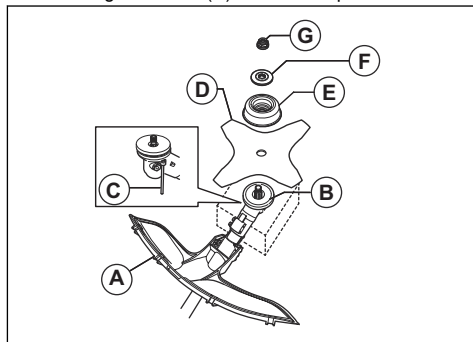

Assembly of the trimmer guard and the trimmer head

To attach the trimmer guard

1. Attach the plate holder to the gear with the smallest bolt. Tighten the bolt.

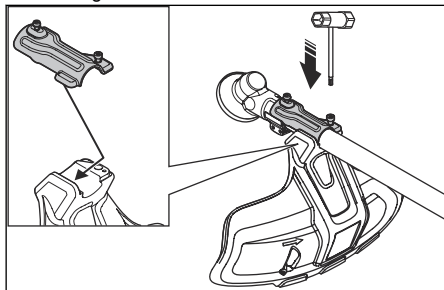

2. Attach the trimmer guard to the plate holder.
3. Attach the biggest bolt and tighten it.

To remove the trimmer guard

1. Remove the bolts.
2. Remove the trimmer guard.

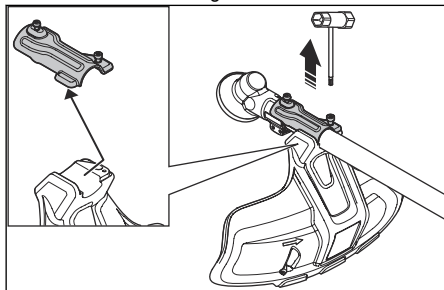

To attach the trimmer head T35 (535iFR, 535iRX)

1. Put the drive disc (B) on the output shaft.
2. Turn the output shaft to align one of the holes in the drive disc with the related hole in the gear housing.
3. Put the locking pin (C) in the hole to lock the shaft.

4. Turn the trimmer head (H) counterclockwise to attach.

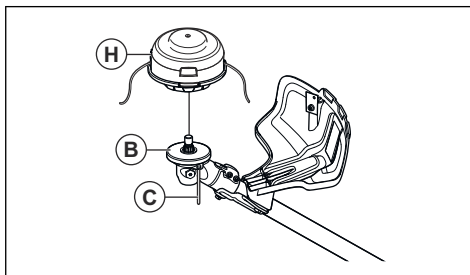

To remove the trimmer head T35 (535iFR, 535iRX)

1. Put the locking pin (C) in the hole to lock the shaft.
2. Turn the trimmer head (H) clockwise to remove it.
3. Remove the drive disc (B) from the output shaft.

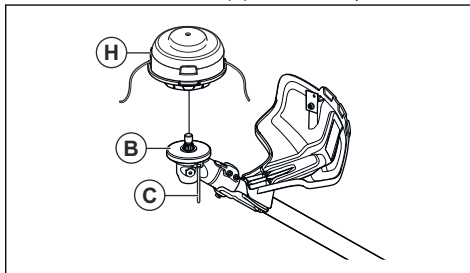

To attach the trimmer head E35B (535iRXT)

Note: To increase the life of the cord it can be soaked in water for a couple of days before it is assembled. This will make the cord tougher.

1. Put the drive disc (B) on the output shaft.
2. Turn the output shaft to align one of the holes in the drive disc with the related hole in the gear housing.
3. Put the locking pin (C) into the hole to lock the shaft.
4. Attach the trimmer head (H).

5. Install the nut (G).

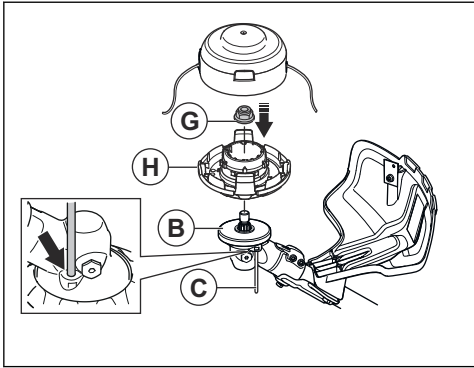

6. Install the line chute and the trimmer head cover (F).

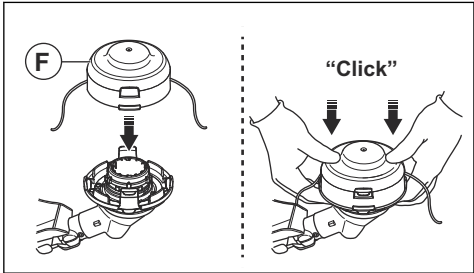

To remove the trimmer head E35B (535iRXT)

Note: To increase the life of the cord it can be soaked in water for a couple of days before it is assembled. This will make the cord tougher.

1. Put the locking pin in the hole to lock the shaft.
2. Press the snap-in clips on the trimmer head and remove the trimmer head and trimmer line chute.

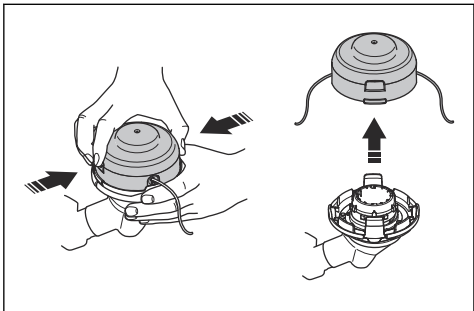

3. Remove the nut that holds the trimmer head and the drive disc.

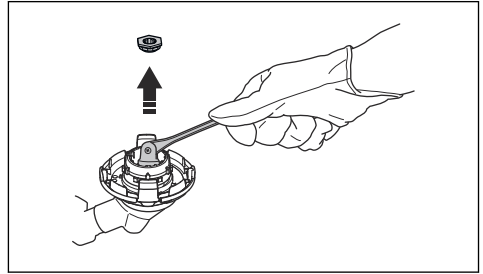

4. Remove the trimmer head.

Assembly of the saw blade guard and the saw blade

To attach the saw blade guard (535iFR)

1. Attach the holder (A) and bracket (B) with 2 bolts (C) on the gear housing (D).
2. Attach the saw blade guard (E) with 4 bolts (F) in the holder (A).

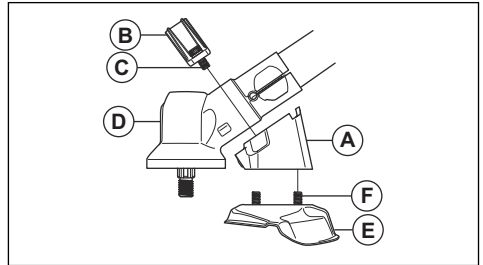

To remove the saw blade guard (535iFR)

1. Remove the 4 bolts (L) from the holder (R) and remove the saw blade guard (A).

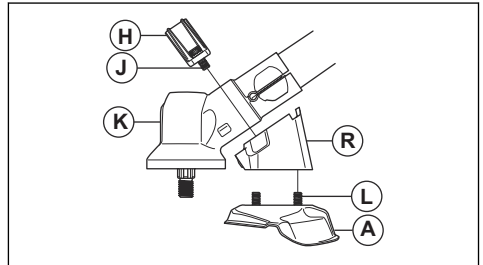

2. Remove the 2 bolts (J) on the gear housing (K). Remove the holder (R) and the bracket (H).

To attach the saw blade (535iFR)

1. Put the drive disc (A) on the output shaft.
2. Turn the output shaft to align 1 of the holes in the drive disc with the related hole in the gear housing.

- Put the locking pin (B) in the hole to lock the shaft.
- Put the saw blade (C) and the support flange (D) on the output shaft.

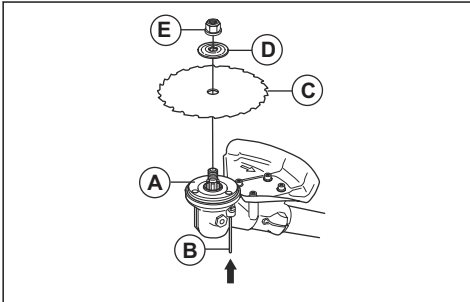

- Make sure that the drive disc and support flange engages correctly in the center hole of the grass blade.

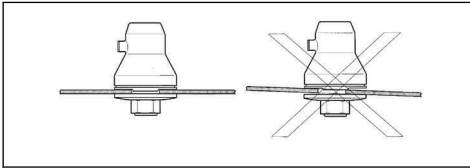

- Attach the locknut (E).
- Tighten the locknut with the socket wrench. Hold the shaft of the socket wrench near the blade guard. Tighten in the opposite direction to how the cutting attachment rotates. Tighten it to a torque of 35-50 Nm.

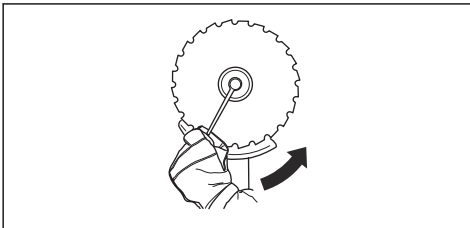

To remove the saw blade (535iFR)

- Put the locking pin (C) into the hole to lock the shaft.
- Remove the nut the nut (G).

- Remove the support flange (F) and the saw blade (D) from the output shaft.

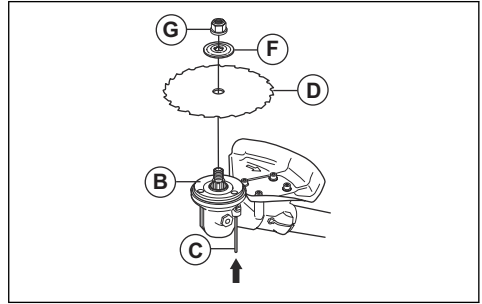

- Remove the drive disc (B) from the output shaft.

To adjust the Balance XB harness (535iRXT)

- Put the harness on.
- Push the 2 parts of the breastplate together as shown in the illustration.

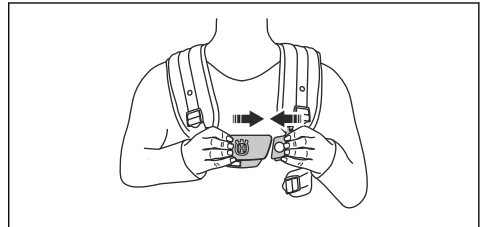

- Tighten the hip strap tightly. Make sure that the hip strap aligns with the hip.

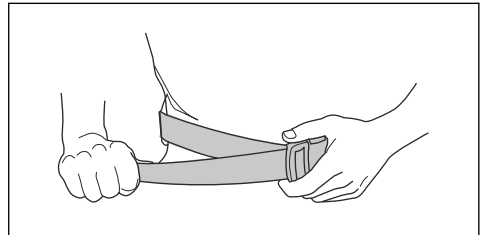

- Tighten the chest strap below your left arm tightly. The chest strap must be tight against your body.

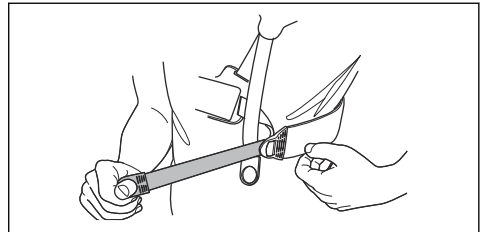

5. Adjust the shoulder strap until the weight is equal on the 2 shoulders.

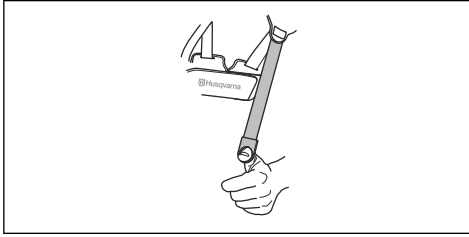

6. Adjust the height of the suspension point. For forestry clearing, the correct height of the suspension is approximately 10 cm below your hip. Refer to *Correct balance of the product on page 18*.
7. Attach the battery carrier to the harness.

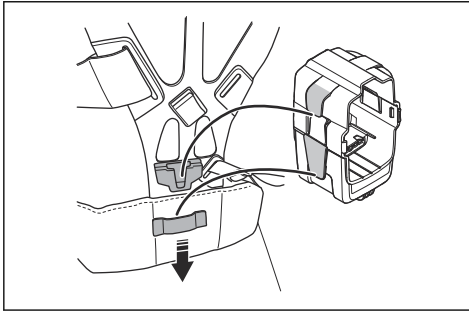

Note: It is possible to attach 1 extra battery to the battery carrier. The battery carrier is available as an accessory.

8. Attach a battery.

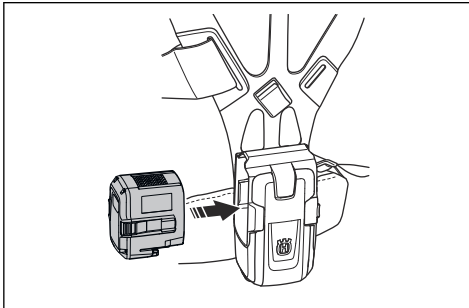

To adjust the harness (535iFR, 535iRX)



WARNING: Always attach this product to the harness correctly. If not, you cannot control the product safely and this can result in injury to you or others. Do not use a harness with a defective quick release.



WARNING: Use the harness quick release function if you must release from the product and the harness in an emergency situation.

1. Put on the harness.
2. Adjust the harness for the best work position.
3. Adjust the side straps until the weight is equally applied across your shoulders.



4. Adjust the harness until the cutting attachment is parallel to the ground.

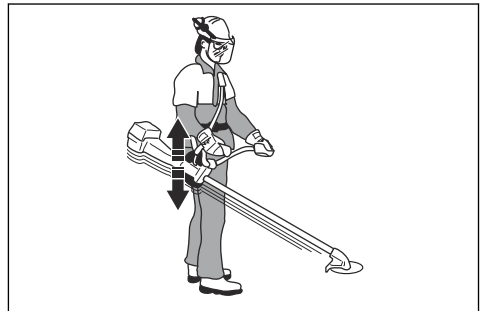

5. If the operation is to cut grass, let the cutting attachment stay lightly on the ground. Adjust the harness clamp to balance the product correctly.

Operation

Introduction



WARNING: Read and understand the safety chapter before you use the product.

Husqvarna Connect

Husqvarna Connect is a free app for your mobile device. The Husqvarna Connect app gives extended functions for your Husqvarna product.

- Extended product information.

- Information about, and help with, product parts and servicing.

Bluetooth® wireless technology

Products with built-in Bluetooth® wireless technology can connect to mobile devices and enables additional functions from connect.

The symbol for *Bluetooth*® wireless technology comes on when your mobile device is connected to the product.



To start to use Husqvarna Connect

1. Download the Husqvarna Connect app on your mobile device.
2. Register in the Husqvarna Connect app.
3. Follow the instruction steps in the Husqvarna Connect app to connect and register the product.

Note: Husqvarna Connect app is not available for download in all markets.

To connect the battery to the product



WARNING: Only use original Husqvarna battery in the product.

1. Make sure that the battery is fully charged.
2. Slide the battery into the battery holder of the product. The battery must slide easily, if not, it is not installed correct. The battery will lock into position when you hear a click.

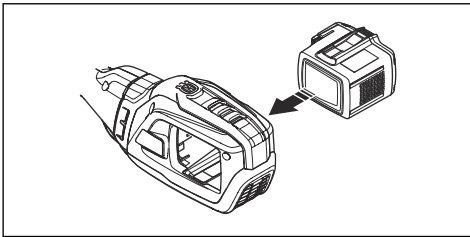

3. Make sure the battery is installed correctly.

Work position

- Hold the product with 2 hands.
- Hold the product on the right side of your body.
- Keep the cutting attachment below waist level.
- Always keep the product attached to the harness.
- Keep body parts away from the hot surfaces.
- Keep body parts away from the cutting attachment.

Correct balance of the product

For forestry clearing, the product is correctly balanced when it freely hangs horizontally from the suspension point. With correct balance, the risk of hitting stones if you release the handlebar is decreased.

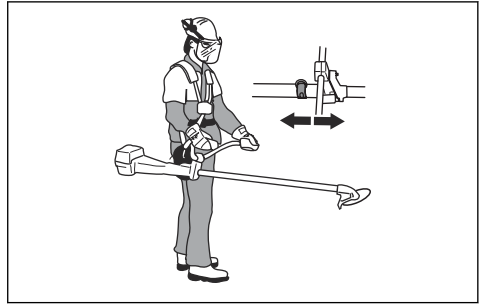

For grass clearing, the product is correctly balanced when the blade is at cutting height near the ground.

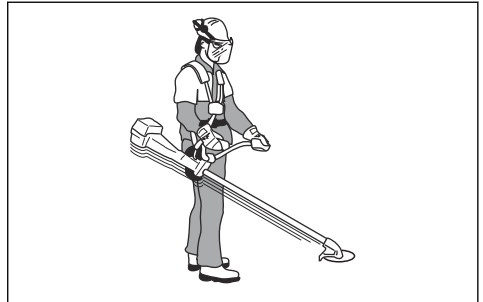

To adjust the balance with the add-on weight

If correct balance is difficult to achieve, attach the add-on weight. The add-on weight is available as an accessory.

- Attach the add-on weight with the bolts.

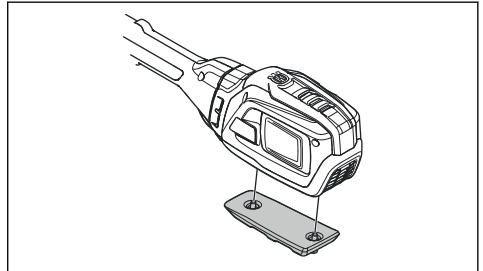

To apply the load equally on the shoulders

1. Adjust the tension of the side straps to apply the weight equally on the shoulders.

- Adjust the harness for the best work position. An adjusted harness and product makes operation easier.

Before you operate the product

- Examine the work area to make sure that you know the type of terrain, the slope of the ground and if there are obstacles such as stones, branches and ditches.
- Do an overhaul inspection of the product.
- Do the safety inspections, maintenance and servicing that are given in this manual.
- Make sure that all covers, guards, handles and the cutting equipment are correctly attached and not damaged.
- Make sure that there are no cracks at the bottom of the saw blade or grass blade teeth or by the center hole of the blade. Replace the blade if it is damaged.

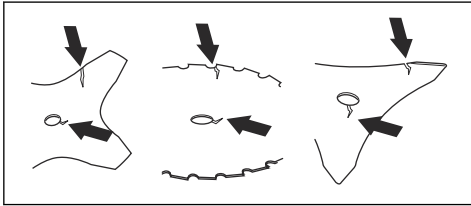

- Examine the support flange for cracks. Replace the support flange if it is damaged.

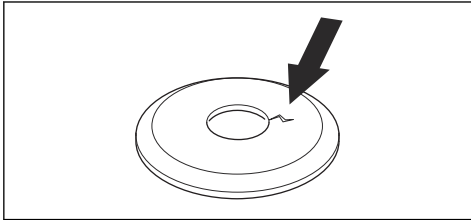

- Make sure that the locknut can not be removed by hand. The locknut must have a locking force of minimum 1.5Nm. Make sure that the tightening torque is between 35-50 Nm.

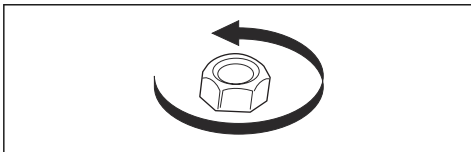

- Examine the blade guard for damages or cracks. Replace the blade guard if it has been hit or if it has cracks.
- Examine the trimmer head and cutting attachment guard for damages or cracks. Replace the trimmer

head and cutting attachment guard if they have been hit or if they have cracks.

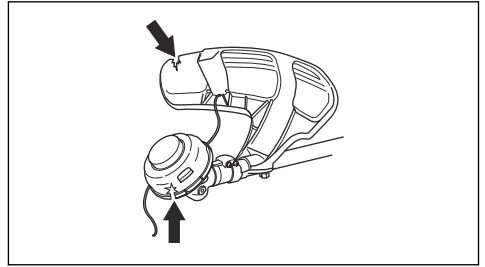

To start the product

Note: The product identifies the cutting attachment when the cutting attachment is changed and the power trigger is pressed. The product stops and the LED flashes until the power trigger is released and moves back to its initial position. The cutting attachment is at this time identified and prepared for operation.

- Push and hold the start button until the green battery LED and the white mode LED comes on.

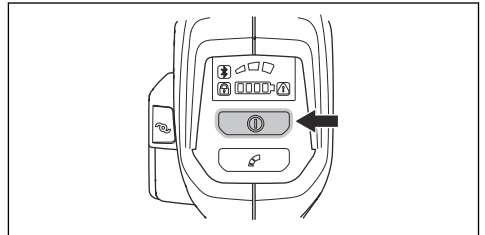

- Use the power trigger to control the speed.

To limit the maximum speed with the mode button

Note: The maximum speed is related to the cutting equipment that is attached and identified by the product. When a blade is attached, the maximum speed is higher than when a trimmer head is attached. Refer to *Technical data on page 27*.

The product has a mode button. With the mode button the operator can limit the maximum speed. The mode button has 3 speed levels. A lower level increases the time of operation for the product. Use level 1 and level 2 if the operation does not require full speed/full power. If the operation condition requires full speed/full power, use level 3. Do not use a higher level than necessary for the operation.

1. Push the mode button to set a limit to the maximum speed. The white LEDs comes on to show that the function is on.

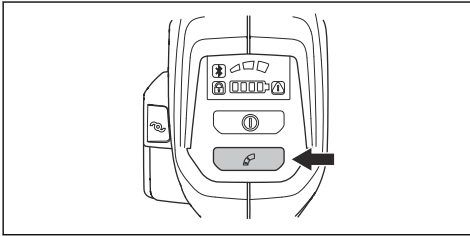

2. Press the Mode button again to choose the next speed level.

To extend the trimmer line with the ErgoFeed function (535iRXT)



CAUTION: Do not hit the ground with the trimmer head to extend the trimmer line.

The product has a function that extend the trimmer line when the ErgoFeed button is pushed. The ErgoFeed function decrease the wear on the trimmer head. It also decreases accidental line supply that can occur when you hit objects, for example, stones and/or hard surfaces.

- Push the ErgoFeed button to start the automatic adjustment of the trimmer line.

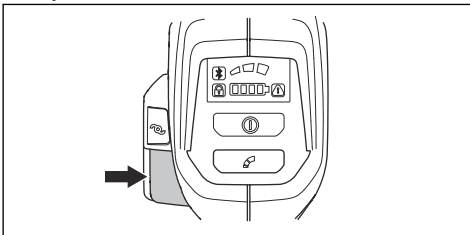

Automatic shutdown function

The product has a shutdown function that stops the product if the product is not used. The green LED for start/stop indication goes off and the product stops after 180 seconds.

Blade thrust

A blade thrust is when the product moves to the side quickly and with force. A blade thrust occurs when the grass blade hits or catches on an object that cannot be cut. A blade thrust can eject the product or operator in

all directions. There is a risk of injury to the operator and bystanders.

The risk increases in areas where it is not easy to see the material that should be cut.

Do not cut with the area of the blade that is shown in grey in the illustration. The speed and movement of the blade can cause blade thrust. The risk increases with the thickness of the stem that is cut.

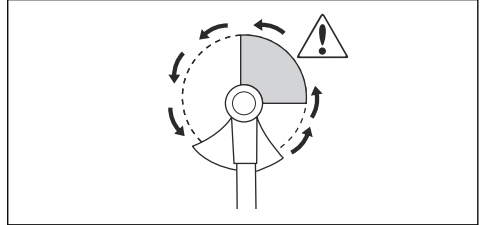

General work instructions



WARNING: Be careful when you cut a tree that is in tension. It can spring back to its normal position before or after the cut and hit you or the product, and cause injury.

- Clear an open space at one end of the work area, and start the work from there.
- Move in a regular pattern across the work area.

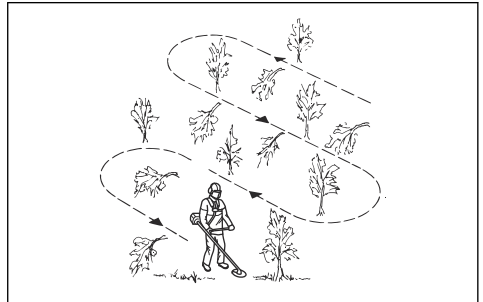

- Move the product fully to the left and right, to clear a width of 4–5 m on each turn.
- Clear a length of 75 m before you turn and go back.
- Move in a direction where you do not go across ditches and obstacles more than necessary.

- Move in a direction where the wind makes the cut vegetation fall in the cleared area.

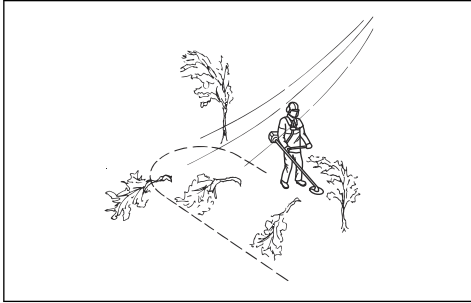

- Move along slopes, not up and down.

Forestry clearing with a saw blade

To fell a tree to the left

To fell to the left, push the bottom of the tree to the right.

1. Apply full throttle.
2. Put the saw blade against the tree as given in the picture.
3. Tilt the saw blade and push it with force diagonally down to the right. At the same time, push the tree with the blade guard.

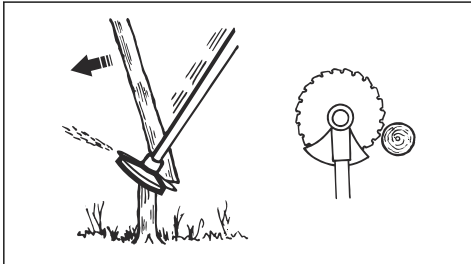

To fell a tree to the right

To fell to the right, push the bottom of the tree to the left.

1. Apply full throttle.
2. Put the saw blade against the tree as given in the picture.

3. Tilt the saw blade and push it with force diagonally up and to the right. At the same time, push the tree with the blade guard.

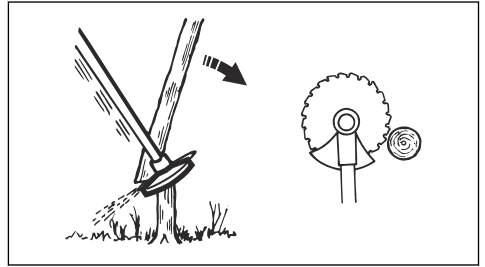

To fell a tree forward

To fell forward, push the bottom of the tree rearward.

1. Apply full throttle.
2. Put the saw blade against the tree as given in the picture.
3. Pull the saw blade forward with a fast movement.

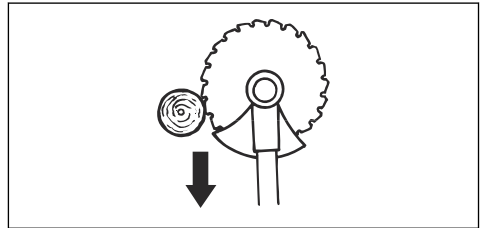

To fell large trees

Large trees must be cut from 2 sides.

1. Examine in which direction the tree will fall.
2. Apply full throttle.
3. Do the first cut on the side of the tree to which it will fall.

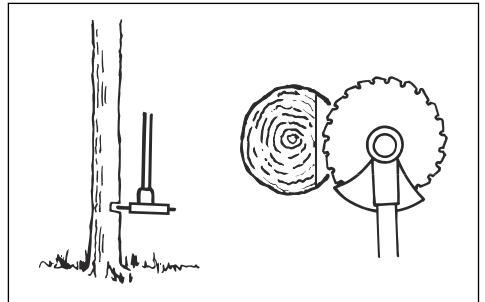

- Cut through the tree from the other side.

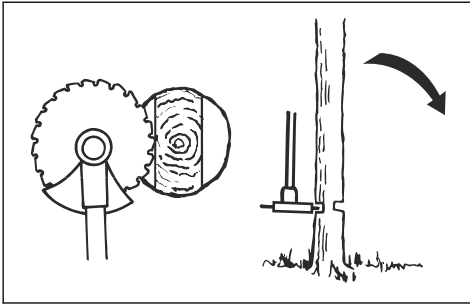

CAUTION: If the saw blade becomes blocked, do not pull the product with a sudden movement. That can cause damage to the saw blade, bevel gear, shaft or handlebar. Release the handles, hold the shaft with 2 hands and carefully pull the product.

Note: Use more cutting pressure to fell small trees. Use less cutting pressure to fell large trees.

Brush cutting with a saw blade

To fell to the left, push the bottom of the tree to the right.

- Cut down thin trees and brush.
- Move the product from side to side.
- Cut many trees in one movement.
- For groups of thin trees:

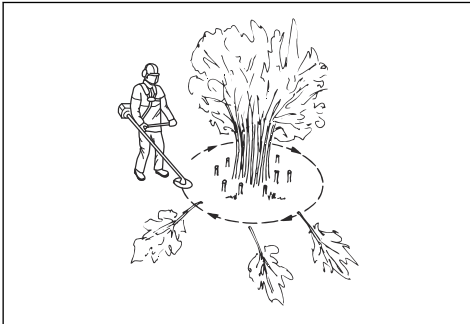

- Cut the outer trees high up.
- Cut the outer trees to the correct height.
- Cut from the center. If you cannot get access to the center, cut the outer trees high up and let them fall. This decreases the risk that the saw blade becomes blocked.

To clear grass with a grass blade

- Grass blades and grass cutters must not be used on woody stems.

- A grass blade is used for all types of tall or coarse grass.
- The grass is cut down with a sideways, swinging movement, where the movement from right-to-left is the clearing stroke and the movement from left-to-right is the return stroke. Let the left-hand side of the blade (between 8 and 12 o'clock) do the cutting.
- If the blade is angled to the left when clearing grass, the grass will collect in a line, which makes it easier to collect, e.g. by raking.
- Try to work rhythmically. Stand firmly with your feet apart. Move forward after the return stroke and stand firmly again.
- Let the support cup rest lightly against the ground. It is used to protect the blade from hitting the ground.
- Reduce the risk of material wrapping around the blade by always work at full speed and avoid the previously cut material during the return stroke.
- Stop the motor, unclip the harness and place the machine on the ground before you start to collect the cut material.

Grass trimming with a trimmer head

To trim the grass

- Hold the trimmer head immediately above the ground at an angle.

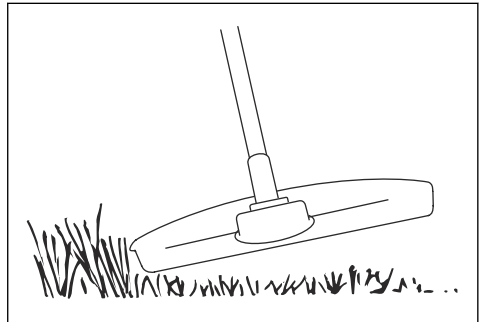

Do not push the grass trimmer line into the grass.

- Decrease the length of the grass trimmer line by 10-12 cm (4-4.75 in) and decrease the motor speed to decrease the risk of damage to plants.

- Use 80 % speed when you cut grass near objects.

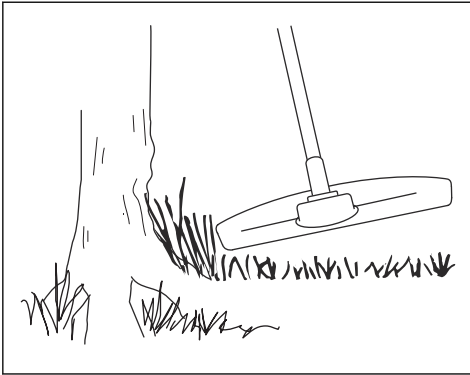

To cut the grass

- Make sure that the grass trimmer line is parallel to the ground when you cut.

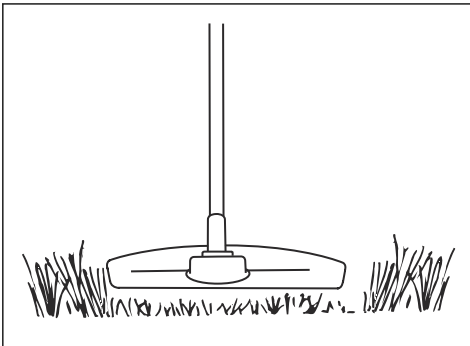

- Do not push the trimmer head to the ground. The ground and the product can be damaged.
- Do not let the trimmer head touch the ground continuously, it can cause damage to the trimmer head.

- Use full speed when you move the product from side to side to cut grass.

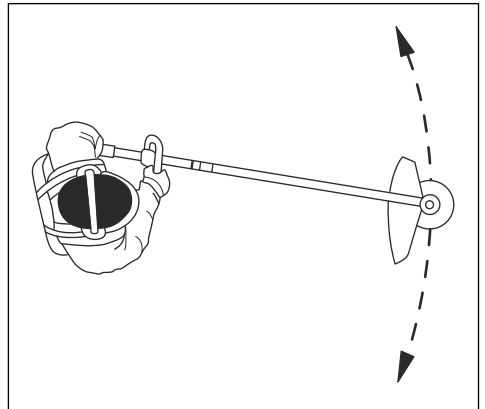

Make sure that the grass trimmer line is parallel to the ground.

To sweep the grass

The airflow from the rotating trimmer line can be used to remove cut grass from an area.

- Hold the trimmer head and the trimmer line parallel to the ground and above the ground.
- Apply full throttle.
- Move the trimmer head from side to side and sweep the grass.



WARNING: Clean the trimmer head cover each time you assemble new trimmer line to prevent unbalance and vibrations in the handles. Also do a check of the other parts of the trimmer head and clean it if necessary.

To stop the product

- Release the power trigger and the power trigger lockout.
- Press the start/stop button until the green LED is out.
- Press the release buttons on the battery and pull the battery out.

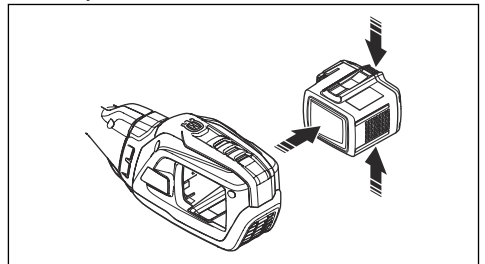

Maintenance

Introduction



WARNING: Before you do any maintenance work you must read and understand the safety chapter.

The following is a list of the maintenance steps that you must do on the product. See *Maintenance on page 24* for more information.

Maintenance schedule



WARNING: Remove the battery before you do maintenance.

Maintenance	Daily	Weekly	Monthly
Clean the external parts of the product with a dry cloth. Do not use water.	X		
Examine that the start and stop button works correctly and is not damaged.	X		
Make sure that the power trigger and the power trigger lockout function correctly from a safety point of view.	X		
Make sure that all controls work and are not damaged.	X		
Keep the handles dry, clean and free from oil and grease.	X		
Make sure that the cutting attachment is not damaged. Replace the cutting attachment if it is damaged.	X		
Make sure that the cutting attachment guard is not damaged. Replace the cutting attachment guard if it is damaged.	X		
Make sure that the screws and nuts are tight.	X		
Make sure that the battery release buttons on the battery works and locks the battery in the product.	X		
Examine that the battery charger is not damaged and function correctly.	X		
Make sure that the battery is not damaged.	X		
Make sure that the suspension ring is not damaged.	X		
Make sure that the handle and the handlebar is not damaged and attached correctly.	X		
Make sure that the blade is correctly centered, is sharp, and not damaged. An off-center blade will cause vibration that could result in damage to the product.	X		
Make sure that the locknut of the cutting equipment is tighten correctly.	X		
Make sure that the transport guard for the blade is not damaged and that the transport guard can be attached correctly.	X		
Examine all couplings and connections. Make sure they are not damaged and free from dirt.		X	
Examine the vibration damping elements and make sure that they are not damaged.		X	
Make sure that the bevel gear is filled three-quarters full with lubricant. If not, use special grease.		X	

Maintenance	Daily	Weekly	Monthly
Lubricate the drive shaft end in the lower shaft coupling.		X	
Make sure that the air intake of the motor is not dirty. Clean the air intake with compressed air.		X	
Do a check of the connections between the battery and the product. Do a check of the connection between the battery and the battery charger.			X
Make sure that the safety release on the harness is not damaged and operates correctly.			X

To clean the product, the battery and the battery charger

1. Clean the product with a dry cloth after use.
2. Clean the battery and battery charger with a dry cloth. Keep the battery guide tracks clean.
3. Make sure that the terminals on the battery and the battery charger are clean before the battery is put in the battery charger or the product.

To sharpen the grass knife and grass blade



WARNING: Stop the product and remove the battery. Use protective gloves.

- To sharpen the grass knife or grass blade correctly, refer to the instructions that come with the cutting attachment.
- Sharpen all edges equally to keep the balance.
- Use a single-cut flat file.

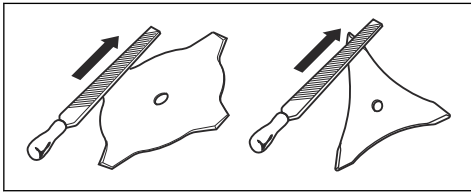

WARNING: Always discard a blade that is damaged. Do not try to make a bent or twisted blade straight and use it again.

To sharpen the saw blade



WARNING: Stop the product and remove the battery. Use protective gloves.

- To sharpen the blade correctly, refer to the instructions that come with the blade.

- Make sure that the product and blade has sufficient support when you sharpen it.

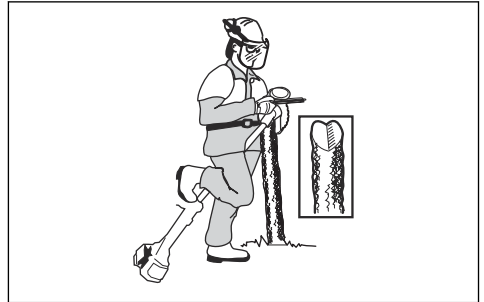

- Use a 5.5 mm (7/32 in) round file with a file holder.

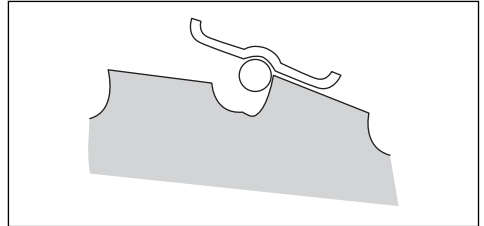

- Hold the file at an angle of 15°.
- Sharpen one tooth of the saw blade to the right and the next tooth to the left, see the illustration.

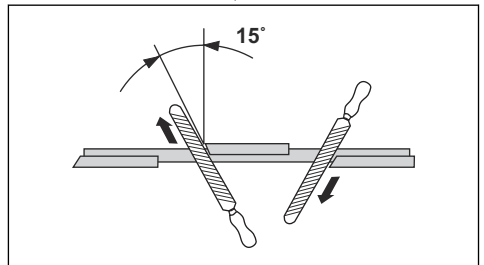

Note: Sharpen the edges of the teeth with a flat file if the blade is heavily worn. Continue to sharpen with a round file.

- Sharpen all edges equally to keep the blade balanced.

- Adjust the blade set to 1 mm (0.04 in) with the recommended setting tool. Refer to the instructions that come with the blade.

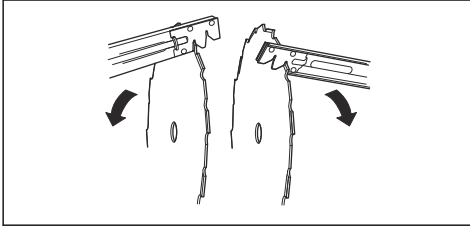

WARNING: Always discard a blade that is damaged. Do not try to make a bent or twisted blade straight and use it again.

changed. Use Husqvarna special grease if it is necessary to fill up. Do not change the grease in the bevel gear. Let servicing personnel do the repair of the bevel gear.

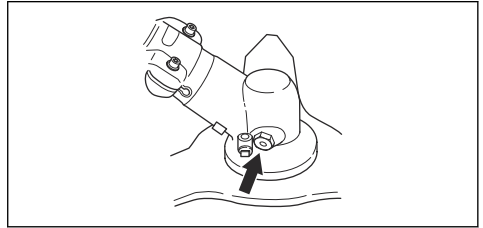

Bevel gear

The bevel gear is filled to $\frac{3}{4}$ with grease at the factory. Before use, make sure that the grease level has not

Troubleshooting

User interface

LED display	Possible faults	Possible action
Battery LED indicator flashes or orange	Low battery voltage.	Charge the battery.
Red error LED flashes	Overload.	The cutting attachment is jammed. deactivate the product. Remove the battery. Clean the cutting attachment from unwanted materials.
	Temperature deviation.	Let the product cool down.
	The power trigger and the activate button are pressed at the same time.	Release the power trigger and the product is active.
The product does not start	Dirt in the battery connectors.	Clean the battery connectors with compressed air or a soft brush.
Error LED is lit with red light	The product needs servicing.	Contact your servicing agent.

Transportation, storage and disposal

Transportation and storage

- The supplied Li-ion batteries obey the Dangerous Goods Legislation requirements.
- Obey the special requirement on package and labels for commercial transportation, including by third parties and forwarding agents.

- Speak to a person with special training in dangerous material before you send the product. Obey all applicable national regulations.
- Use tape on open contacts when you put the battery in a package. Put the battery in the package tightly to prevent movement.
- Remove the battery for storage or transportation.

- Put the battery and the battery charger in a space that is dry and free from moisture and frost.
- Do not keep the battery in an area where static electricity can occur. Do not keep the battery in a metal box.
- Put the battery in storage where the temperature is between 5°C/41°F and 25°C/77°F and away from open sunlight.
- Put the battery charger in storage where the temperature is between 5°C/41°F and 45°C/113°F and away from open sunlight.
- Use the battery charger only when the surrounding temperature is between 5°C/41°F and 40°C/104°F.
- Charge the battery 30% to 50% before you put it in storage for long periods.
- Put the battery charger in storage in a space that is closed and dry.
- Keep the battery away from the battery charger during storage. Do not let children and other not approved persons to touch the equipment. Keep the equipment in a space that you can lock.

- Clean the product and do a full servicing before you put the product in storage for a long time.
- Use the transportation guard on the product to prevent injuries or damage on the product during transportation and storage.
- Attach the product safely during transportation.

Disposal of the battery, battery charger and product

Symbols on the product or the package of the product means that the product is not domestic waste. Recycle it at a recycling station for electrical and electronic equipment. This helps to prevent damage to the environment and to persons.

Get in touch with your local authorities, domestic waste service or your dealer for more information about how to recycle your product.

Technical data

Technical data

	535iFR	535iRXT	535iRX
Motor			
Motor type	Husqvarna e-torc BLDC	Husqvarna e-torc BLDC	Husqvarna e-torc BLDC
Speed of output shaft. Trimmer head/blade, 1/min	5300/8200	5300/8200	5300/8200
Cutting width, mm/in	450/17.7	450/17.7	450/17.7
Weight			
Weight without battery, kg/lb	4.5/9.9	4.9/10.8	4.9/10.8
Noise emissions			
Sound power level, measured dB (A)	93	93	94
Sound power level, guaranteed L _{WA} dB (A)	96	96	96
Noise levels¹			
Sound pressure level at the operator's ear, measured according to IEC 62841-1:			
Equipped with trimmer head (original) dB (A)	80	80	80
Vibration levels²			

¹ Reported data for sound pressure level for the machine has a typical statistical dispersion (standard deviation) of 3 dB (A).

² Reported data for vibration level has a typical statistical dispersion (standard deviation) of 1.5 m/s².

	535iFR	535iRXT	535iRX
Vibration levels at handles, measured according to IEC 62841-1, m/s ²			
Equipped with trimmer head (original), left/right, m/s ²	1.4/1.7	1.2/1.4	1.3/1.4
Equipped with grass blade (original), left/right, m/s ²	2.5/2.0	2.4/2.0	2.4/2.0
Note: For comparison of vibrations levels, battery and combustion products use the vibration calculator. https://www.husqvarna.com/uk/services-solutions/vibration-calculator/			
Radio frequency data for Bluetooth®			
Frequency band, GHz	2.4-2.4835	2.4-2.4835	-
Output power, max dBm 0	0	0	-

Approved batteries

Battery	BLi300
Type	Lithium-ion
Battery capacity, Ah	9.4
Nominal voltage, V	36
Weight, kg (lb)	1.9 (4.2)

Approved battery chargers

Battery charger	QC500
Input voltage, V	100-240
Frequency, Hz	50-60
Power, W	500

Accessories

Accessories

Approved accessories	Accessory type	Cutting attachment guard, art. no.
Centre hole in blades/knives, Ø 25.4 mm		
Output shaft thread M12		

Approved accessories	Accessory type	Cutting attachment guard, art. no.
Grass blade/grass knife	Multi 255-3 (Ø 255, 3 teeth)	590 88 00-01
	Grass 255-4 (Ø 255, 4 teeth)	590 88 00-01
	Multi 300-3 (Ø 300 3 teeth)	590 88 00-01
Saw blade	Scarlet 200-22 (Ø 200, 22 teeth)	501 32 04-03
Trimmer head	T35, T35x (Ø 2.4 -2.7 mm Whisper twist trimmer line)	590 88 01-01
	E35B (Ø 2.4 -2.7 mm Whisper twist trimmer line)	590 88 01-01
Support cup	Fixed	

Accessory type	Article number
Battery carrier	590 11 42-01
Balance XB	597 33 12-01

EC Declaration of Conformity

EC Declaration of conformity (products with Bluetooth®)

Husqvarna AB, SE-561 82 Huskvarna, Sweden, tel: +46-36-146500, declare that the Brush cutters **Husqvarna 535IFR, 535IRXT** with serial numbers dating from 2019 onwards (the year is clearly stated on the rating plate, followed by the serial number), comply with the requirements of the COUNCIL'S DIRECTIVE:

- of May 17, 2006 "relating to machinery" **2006/42/EC**.
- of April 16, 2014 "relating to Radio Equipment" **2014/53/EU**.
- of May 8, 2000 "relating to the noise emissions in the environment" **2000/14/EC**.
- of June 8, 2011 on the "restriction of use of certain hazardous substances in electrical and electronic equipment" **2011/65/EU**.

The following standards have been applied:

EN ISO 11806-1:2011, ISO 14982:2009, IEC 62841-1:2014, EN 300328 v2.1.1, EN 62311, ETSI 301 489-1 v.2.1.1, ETSI 301 489-17 v.3.1.1, EN 50581:2012

RISE SMP Svensk Maskinprovning AB, Box 7035, SE-750 07 Uppsala, Sweden, has carried out a voluntary examination on behalf of **Husqvarna AB**. The certificate has the number: **SEC/19/2533**

RISE SMP Svensk Maskinprovning AB has also verified agreement with appendix V of the council's directive 2000/14/EC. The certificates have the numbers: **01/1610/008 and 01/1610/009**.

For information relating to noise emissions, refer to *Technical data on page 27*.

Huskvarna, 2019-06-28



Pär Martinsson, Development Manager (Authorized representative for Husqvarna AB and responsible for technical documentation.)

EC Declaration of conformity (Products without Bluetooth®)

Husqvarna AB, SE-561 82 Huskvarna, Sweden, tel: +46-36-146500, declare that the Brush cutters **Husqvarna 535IFR, 535IRX** with serial numbers dating from 2019 onwards (the year is clearly stated on the rating plate, followed by the serial number), comply with the requirements of the COUNCIL'S DIRECTIVE:

- of May 17, 2006 "relating to machinery" **2006/42/EC**.
- of February 26, 2014 "relating to electromagnetic compatibility" **2014/30/EU**.
- of May 8, 2000 "relating to the noise emissions in the environment" **2000/14/EC**.
- of June 8, 2011 on the "restriction of use of certain hazardous substances in electrical and electronic equipment" **2011/65/EU**.

The following standards have been applied:

EN ISO 11806-1:2011, ISO 14982:2009, IEC 62841-1:2014, IEC 61000-6-1:2016, IEC 61000-6-3:2006+AMD1:2010, EN 62311, EN50581:2012

RISE SMP Svensk Maskinprovning AB, Box 7035, SE-750 07 Uppsala, Sweden, has carried out a voluntary examination on behalf of **Husqvarna AB**. The certificate has the number: **SEC/19/2533**

RISE SMP Svensk Maskinprovning AB has also verified agreement with appendix V of the council's directive 2000/14/EC. The certificates have the numbers: **01/1610/008 and 01/1610/009**.

For information relating to noise emissions, refer to *Technical data on page 27*.

Huskvarna, 2019-06-28



Pär Martinsson, Development Manager (Authorized representative for Husqvarna AB and responsible for technical documentation.)

Registered trademarks

The **Bluetooth®** word mark and logos are registered trademarks owned by **Bluetooth SIG, inc.** and any use of such marks by Husqvarna is under license.



www.husqvarna.com

Original instructions

1159438-26



2020-08-20